

Powered by



# GP 12340 ▶ 12V 34Ah

GP 12340 is a general purpose battery up to 5 years in standby service or more than 260 cycles at 100% discharge in cycle service. As with all CSB batteries, all are rechargeable, highly efficient, leak proof and maintenance free.



## ► Specification

|  |  |
|--|--|
| Cells Per Unit                             | 6  |
| Voltage Per Unit                           | 12   |
| Capacity                                   | 34 Ah @ 20hr-rate to 1.75V per cell @25°C (77°F)   |
| Weight                                     | Approx. 10.48 kg(23.06 lbs)  |
| Maximum Discharge Current                  | 380A(5sec)   |
| Internal Resistance                        | Approx. 8 mΩ   |
| Operating Temperature Range                | Discharge: -15°C~50°C ( 5°F~122°F)<br>Charge: -15°C~40°C ( 5°F~104°F)<br>Storage: -15°C~40°C ( 5°F~104°F)  |
| Nominal Operating Temperature Range        | 25°C±3°C (77°F±5°F)  |
| Float Charging Voltage                     | 13.5 to 13.8 VDC/unit Average at 25°C(77°F)  |
| Recommended Maximum Charging Current Limit | 10.2A  |
| Equalization and Cycle Service             | 14.4 to 15.0 VDC/unit Average at 25°C(77°F)  |
| Self Discharge                             | CSB Batteries can be stored for more than 6 months at 25°C(77°F). Please charge batteries before using. For higher temperatures the time interval will be shorter. |
| Terminal                                   | B5-L terminal to accept M6 nut & bolt  |
| Container Material                         | ABS(UL 94-HB) & Flammability resistance of (UL 94-V0) can be available upon request.   |



MH14533(N)



No.:041005117



CSB-manufactured VRLA batteries are UL-recognized components under UL1989.

CSB is also certified by ISO 9001 and ISO 14001.

## ► Dimensions :

| Unit: mm (inch) | Overall Height (H)  | Container height (h) | Length (L)         | Width (W)           |
|-----------------|---------------------|----------------------|--------------------|---------------------|
|                 | 178.3±2 (7.02±0.08) | 154.8±2 (6.09±0.08)  | 195.6±2 (7.7±0.08) | 130±1.5 (5.12±0.06) |

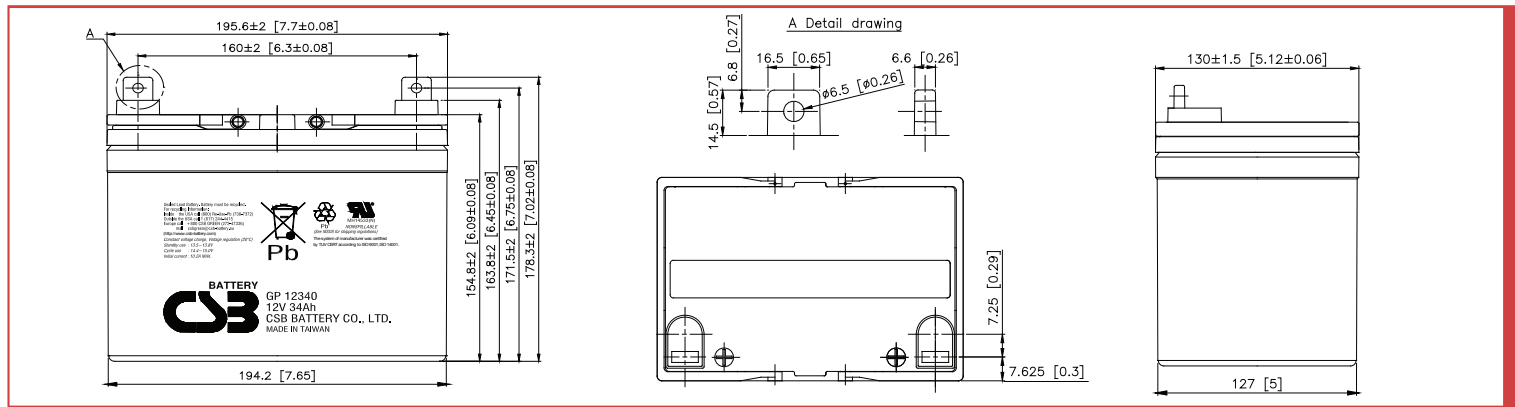

## Constant Current Discharge Characteristics Unit:A (25°C,77°F)

| F.V/Time | 5MIN | 10MIN | 15MIN | 30MIN | 60MIN | 90MIN | 2HR  | 3HR  | 5HR  | 8HR  | 10HR | 20HR |
|----------|------|-------|-------|-------|-------|-------|------|------|------|------|------|------|
| 1.60V    | 144  | 91.7  | 69.3  | 42.1  | 25.0  | 18.2  | 14.5 | 10.3 | 6.55 | 4.26 | 3.48 | 1.86 |
| 1.67V    | 128  | 85.5  | 65.5  | 41.3  | 24.7  | 18.0  | 14.4 | 10.2 | 6.50 | 4.23 | 3.43 | 1.78 |
| 1.70V    | 121  | 82.8  | 63.8  | 40.8  | 24.5  | 17.9  | 14.3 | 10.1 | 6.49 | 4.23 | 3.41 | 1.75 |
| 1.75V    | 110  | 77.5  | 61.2  | 40.0  | 24.4  | 17.8  | 14.2 | 10.0 | 6.47 | 4.18 | 3.35 | 1.69 |
| 1.80V    | 98.0 | 72.3  | 58.8  | 39.2  | 24.0  | 17.6  | 14.1 | 9.9  | 6.45 | 4.14 | 3.30 | 1.64 |
| 1.85V    | 86.3 | 67.0  | 55.7  | 38.2  | 23.6  | 17.4  | 14.0 | 9.8  | 6.43 | 4.09 | 3.24 | 1.58 |

## Constant Power Discharge Characteristics Unit:W (25°C,77°F)

| F.V/Time | 5MIN | 10MIN | 15MIN | 30MIN | 60MIN | 90MIN | 2HR | 3HR | 5HR  | 8HR  | 10HR | 20HR |
|----------|------|-------|-------|-------|-------|-------|-----|-----|------|------|------|------|
| 1.60V    | 1732 | 1100  | 832   | 505   | 300   | 218   | 174 | 124 | 78.6 | 51.1 | 41.7 | 21.6 |
| 1.67V    | 1539 | 1026  | 788   | 495   | 297   | 216   | 173 | 123 | 78.1 | 50.8 | 41.1 | 20.7 |
| 1.70V    | 1456 | 994   | 771   | 490   | 295   | 215   | 172 | 122 | 77.9 | 50.7 | 40.9 | 20.3 |
| 1.75V    | 1316 | 931   | 739   | 481   | 292   | 213   | 171 | 121 | 77.7 | 50.2 | 40.3 | 19.6 |
| 1.80V    | 1176 | 867   | 705   | 470   | 288   | 212   | 170 | 120 | 77.4 | 49.6 | 39.6 | 18.9 |
| 1.85V    | 1036 | 804   | 669   | 458   | 283   | 209   | 169 | 119 | 77.2 | 49.1 | 39.0 | 18.2 |

Ratings presented herein are subject to revision without notice. Please refer to [www.csb-battery.com](http://www.csb-battery.com) to confirm the latest version.

### Trickle (or Float) Service Life

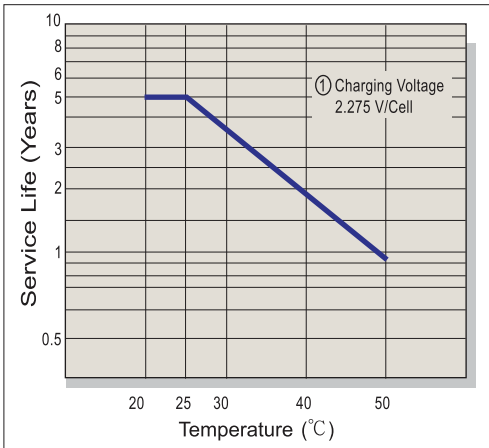

### Capacity Retention Characteristic

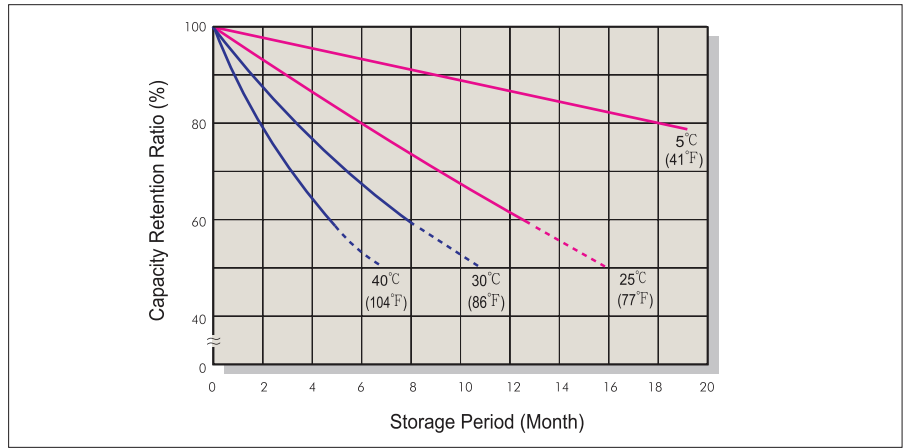

### Battery Voltage and Charge Time for Standby Use

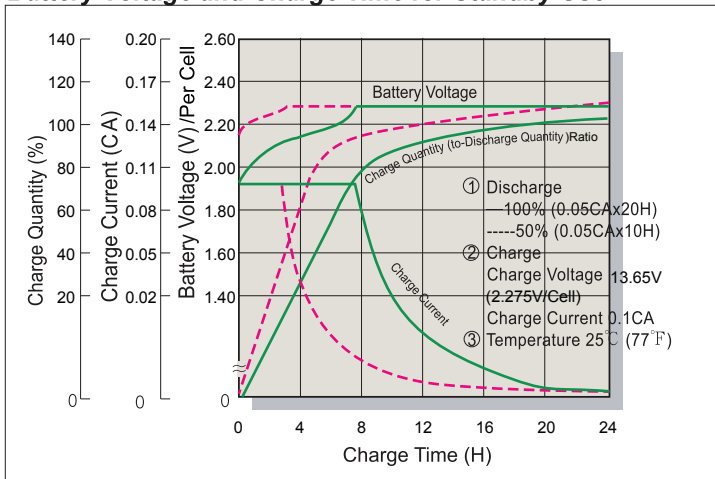

### Cycle Service Life

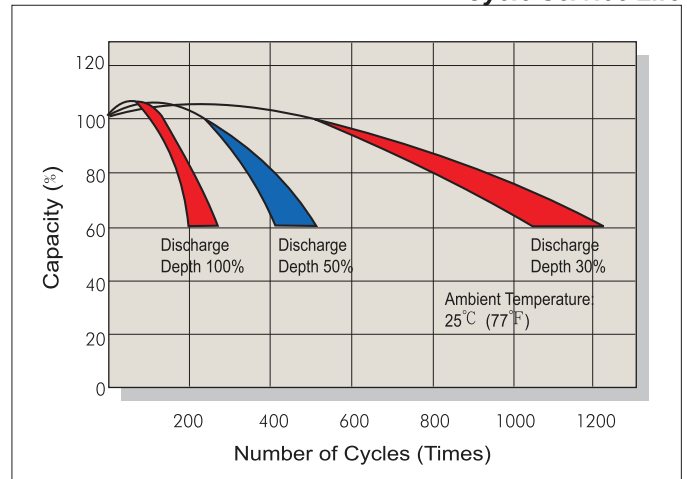

### Battery Voltage and Charge Time for Cycle Use

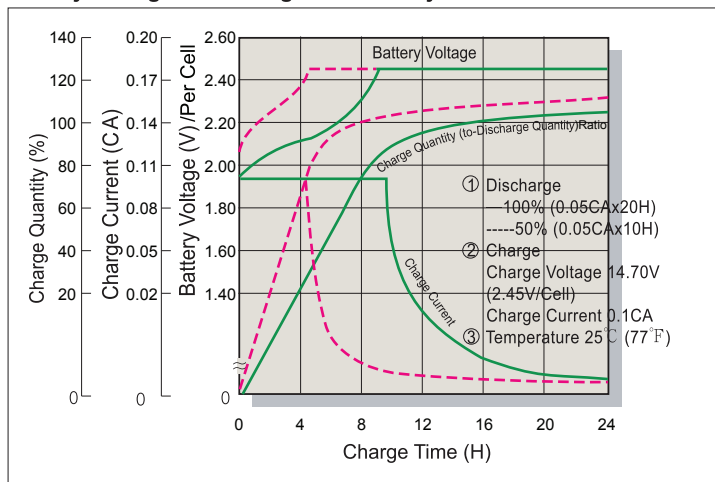

### Terminal Voltage (V) and Discharge Time

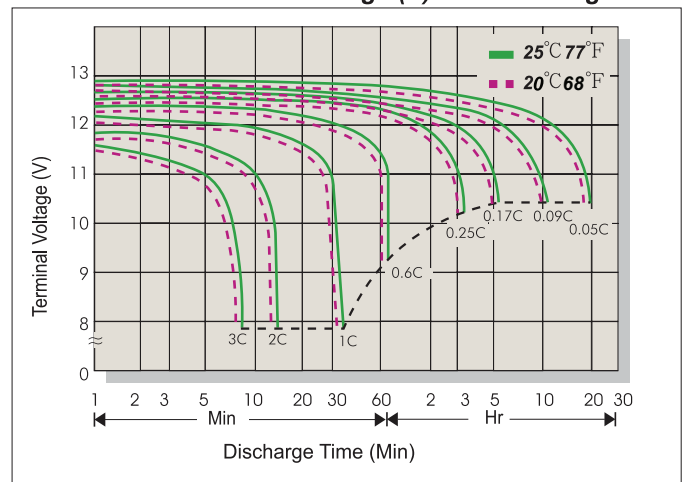

### Charging Procedures

| Application | Charge Voltage(V/Cell) |                           | Max.Charge Current |
|-------------|------------------------|---------------------------|--------------------|
|             | Temperature            | Set Point Allowable Range |                    |
| Cycle Use   | 25°C (77°F)            | 2.45 2.40~2.50            | 0.3C               |
| Standby     | 25°C (77°F)            | 2.275 2.25~2.30           |                    |

### Discharge Current VS. Discharge Voltage

| Final Discharge Voltage V/Cell | 1.75     | 1.70          | 1.60          | 1.30     |
|--------------------------------|----------|---------------|---------------|----------|
| Discharge Current(A)           | 0.2C>(A) | 0.2C<(A)<0.5C | 0.5C<(A)<1.0C | (A)>1.0C |