

# Electrical Equipment / Machine / Switchboard safety

## A 1830 3-phase Active Leakage Adapter

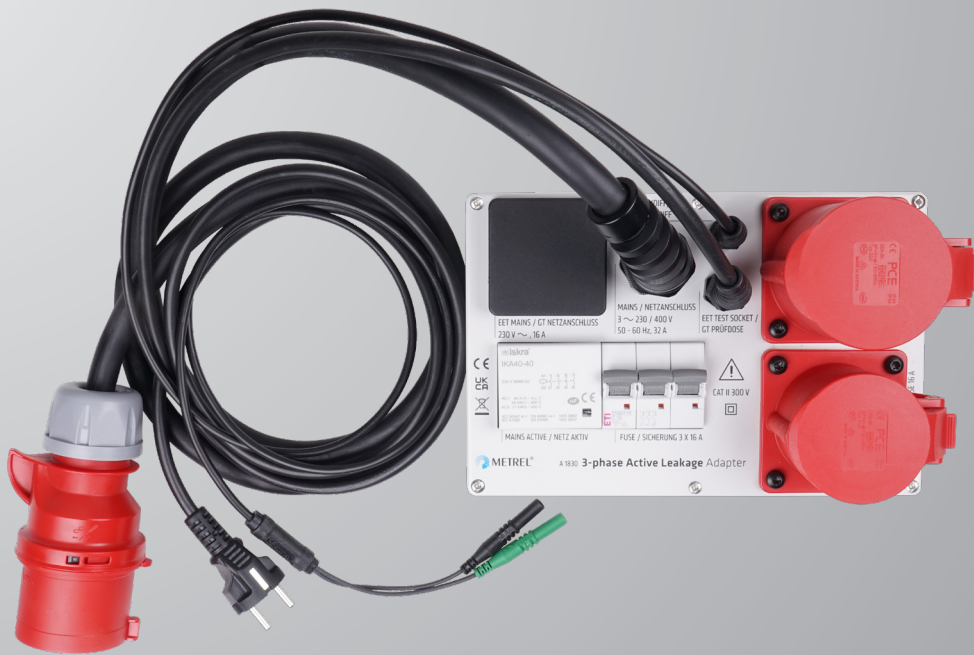

The A 1830 3-phase Active Leakage Adapter is designed for testing, devices which are equipped with a CEE 3-PH/16A 5 pin or CEE 3-PH/32A 5 pin plug. It enables quick and efficient active leakage testing using test instruments primarily designed for testing single phase electrical equipment. If used together with Metrel AUTOSEQUENCES®, prebuilt in the newer multifunctional testers, the complete 3-phase electrical device can be tested with a push of a button. It is possible to create a professional report with MESM SW.

### KEY FEATURES

- Built-in CEE 3-PH/32A 5 pin and CEE 3-PH/16A 5 pin test sockets;
- Active testing on 3-phase electrical equipment can be carried out, including, earth continuity, insulation resistance and live leakage test;
- 3-Phase Equipment AUTO SEQUENCE® support;
- MESM report creation;

### APPLICATION

- The following tests can be performed on devices with CEE plugs with the help of the A 1830 3-Ph Active Leakage Adapter:
  - Protective earth resistance
  - Insulation resistance (Riso, Riso-S)
  - Protective conductor current (Direct, Residual, Alternative);
  - Touch leakage current (Direct, Alternative);
  - Functional test.

### STANDARDS

#### Safety

- EN 61010-1
- EN 61010 - 2 - 030

#### Functionality

- EN 50678 / VDE 0701
- EN 50699 / VDE 0702

### SUPPORTED TEST INSTRUMENTS

- MI 3360 Series
- MI 3365 Series
- MI 3340 Series

## TECHNICAL SPECIFICATION

FUNCTION	Measurement specification
Protective earth resistance	Technical specifications of EE test instrument apply
Insulation resistance	Technical specifications of EE test instrument apply
<b>Protective conductor current</b>	
Direct method (PE leakage)	Technical specifications of EE test instrument apply
Residual method (Differential leakage)	Technical specifications of EE test instrument apply
Alternative method (Substitute leakage)	Technical specifications of EE test instrument apply
<b>Touch current</b>	
Direct method (Touch leakage)	Technical specifications of EE test instrument apply
Alternative method (Substitute leakage-S)	Technical specifications of EE test instrument apply
<b>GENERAL DATA</b>	
Test connector	CEE 3-PH/16A 5pin CEE 3-PH/32A 5pin
Instrument supply connector	1-Ph / 16A
Maximum load current	32 A continuous on 32 A test socket / 16 A continuous on 16 A test socket
Protection classification	Double insulation
Pollution degree	2
Protection degree	IP 40
Overvoltage category	CAT II 300V
Supply voltage, frequency	3~ 400 V, 50 Hz / 60 Hz
Dimensions (w x h x l)	25 cm x 16 cm x 16 cm (without cable glands and cables)
Test leads length	1.5 m
Weight	4.3 kg
<b>Operation conditions</b>	
Working temperature range	0 °C ... +40 °C
Maximum relative humidity	95 % RH (0 °C ... 40 °C), non-condensing
Operation	Indoor use
Altitude	≤2000 m
<b>Storage conditions</b>	
Temperature range	-10 °C ... +70 °C
Maximum relative humidity	90 % RH (-10 °C ... +40 °C) 80 % RH (40 °C ... 60 °C)

## ORDERING INFORMATION

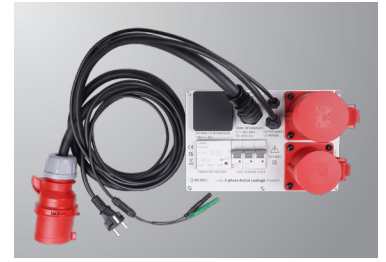

### Standard set A 1830

- A 1830 3-Ph Active Leakage Adapter
- Instruction manual

## OPTIONAL ACCESSORIES

Photo	Order No.	Description
	A 1809	3 phase adapter CEE-RED 16A/CEE-RED 32A

Three-phase mains adapter allows the connection of test adapter A 1830 to a 16 A CEE mains socket.

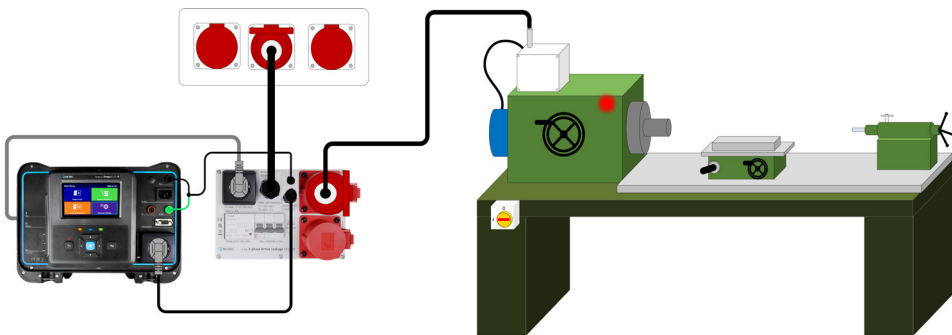

Leakage current measurement

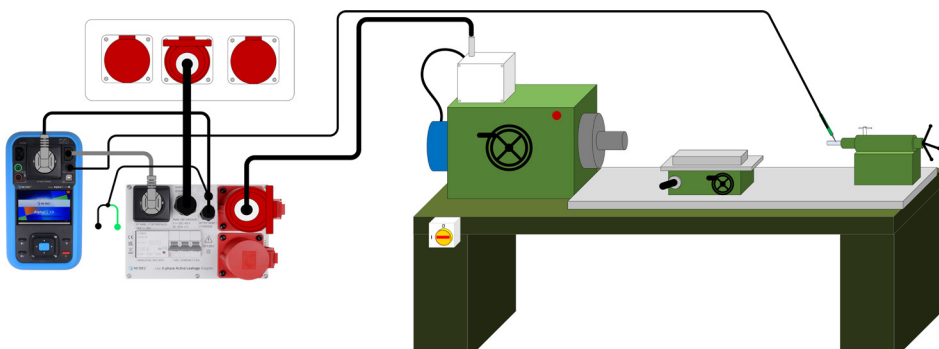

Earth continuity measurement

### METREL d.o.o.

Test and Measurement Equipment  
Ljubljanska 77, SI-1354 Horjul, Slovenia  
T +386 (0)1 75 58 200  
info@metrel.si  
www.metrel.si

Note! Photographs in this catalogue may slightly differ from the instruments at the time of delivery.  
Subject to technical change without notice.