

### LFP01



#### FEATURES:

- **Ultra Light Weight:** 1/3 of normal lead acid battery
- **Excellent Cycle Life:** Over 2000 cycles under JISD standard (lead acid battery only 300 cycles)
- **Premium Charge Acceptance:** Rechargeable with 10C current and 90% recharged within 6 minutes
- **Perfect Shelf Life:** Exceed one year (lead- acid battery 6 months)
- **Highly Safety:** LiFePO4 material and soft pack process ensure the safety performance
- **Multiple Position:** Any direction installation permit since no acid inside-non Spill and non leak
- **Maintenance Free:** 100% maintenance free after EX-WORK date
- **Environment Friendly:** No pollution, no acid, no lead, no heavy metal

### SPECIFICATION

Nominal Voltage: (V)	12.8
Capacity(C10,25°C): (Ah)	≥2.0Ah *90%
Weight: (kg)	Approx. 0.5
Charging Current: (A)	STD.: 1.0A; MAX.: 10.0A
Charging Voltage: (V)	14.4±0.5V
High Rate Discharge: (40A, 25°C)	5s Voltage ≥10.0V, 90s Voltage ≥7.2V
High Rate Discharge: (40A, 0°C)	5s Voltage ≥8.5V, 90s Voltage ≥7.2V
CCA Tested by Digital Tester: (A)	120
Operating Temperature Range	Charge: 0~45°C
	Discharge: -10~60°C
	Storage: -20~40°C
Cycle Life:	≥1000 (100% DOD)
Self Discharge:	Battery can be stored for more than 12 months at 25°C (for higher temperature the self discharge will be faster). Check the battery voltage before using, recharge it if battery voltage less than 12.8V.

#### Charge Characteristic

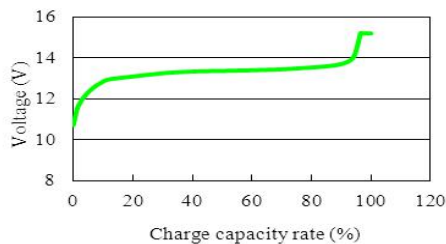

#### Cycle Life

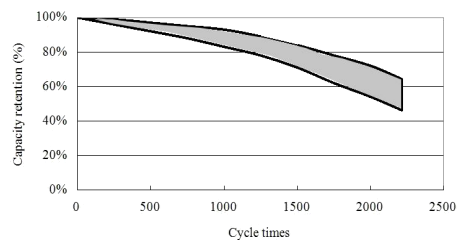

#### Battery Drawing (±2mm): L92 X W52 X H90

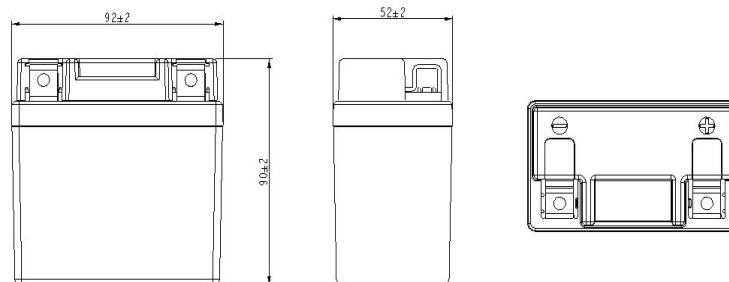

#### Terminal Drawing:

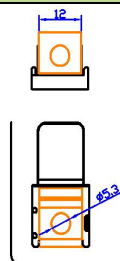

#### Screw and Nut Drawing:

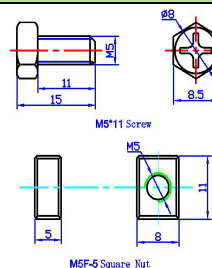

#### Manufacturer Certificate:

TS16949; ISO9001; IS14001; ISO18001

#### Product Certificate:

UL1642 cell inside; CE; RoHs; UN38.3